



LESSEL



21 Baroque Gardens Grand Canal Avenue, London, SE16 7EH

£650 Per Week



21 Baroque Gardens Grand Canal Avenue, London, SE16 7EH

£650 Per Week

Lessel Letting are delighted to offer a stunning RECENTLY BUILT first floor (with lift) TWO BEDROOM / TWO BATHROOM APARTMENT for RENT in the highly sought after NEW Berkeley Homes Marine Wharf development in Surry Quays.

Marine Wharf is the exciting new vibrant destination for London's Dockside. Ideally located only minutes from Canada Water and Surrey Quays stations, residents benefit from easy access to Canary Wharf, London Bridge and beyond.

The apartment offers superb contemporary living accommodation of the highest standard throughout with accommodation comprising; a superb spacious living room with wood flooring, recessed lighting and access to a beautiful private balcony overlooking gardens and waterfall feature, master double bedroom with built in cupboards and fabulous fully tiled end-suite bathroom with variable remote control mood lighting and shower over the bath, second double bedroom, main double size tiled luxury shower room with mood lighting, hallway with storage.

All residents have access to a private gymnasium, on-site Tesco supermarket and 24hr concierge.

Description

Situation

Furnished
Council Tax Band:
Available: 17th March 2026



Floor Plans

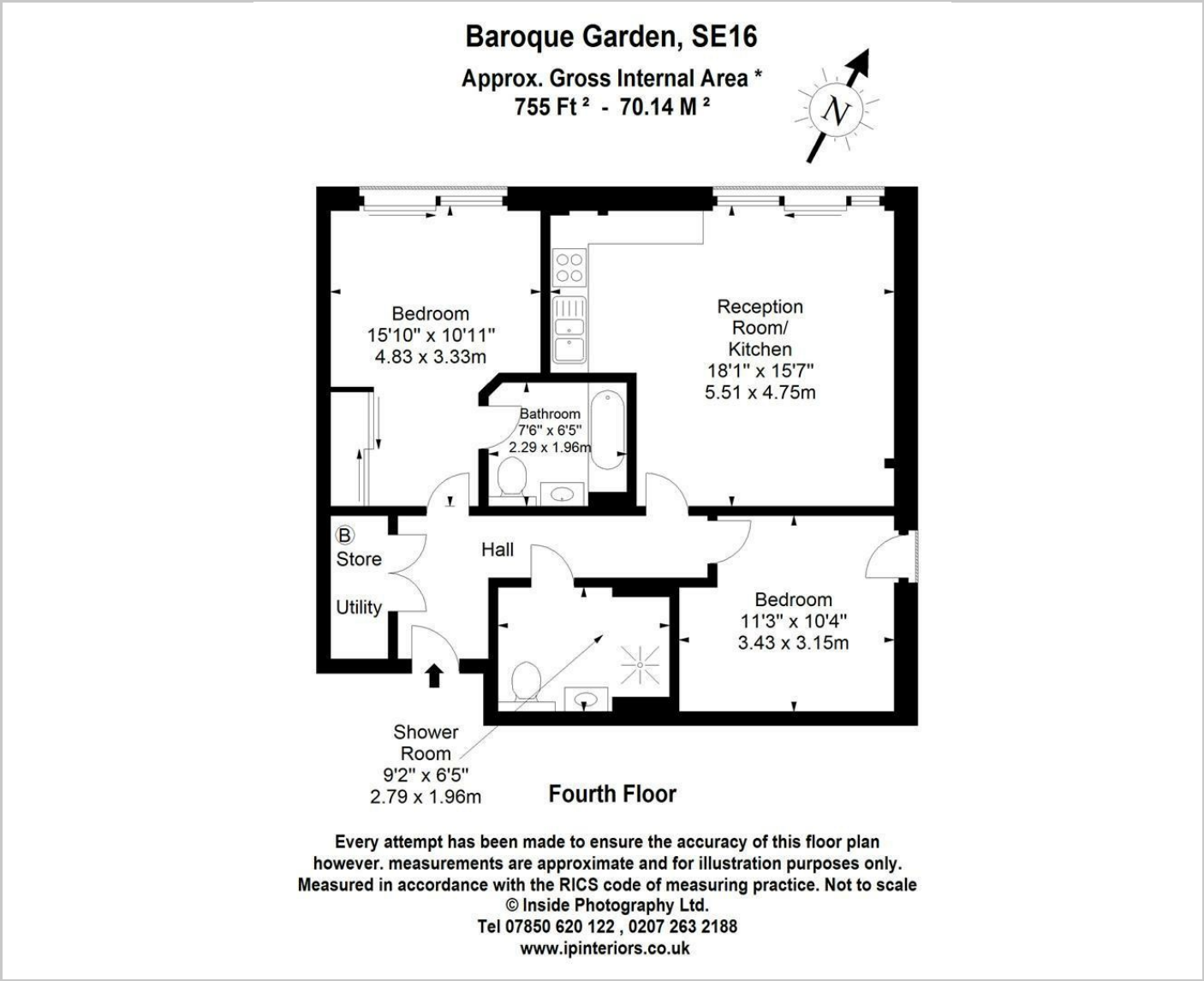

Area Map



Energy Performance Graph

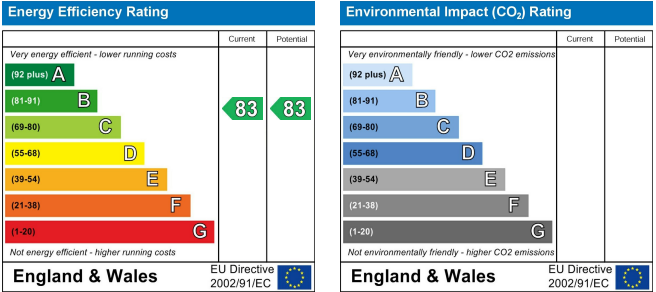

These particulars, whilst believed to be accurate are set out as a general outline only for guidance and do not constitute any part of an offer or contract. Intending purchasers should not rely on them as statements of representation of fact, but must satisfy themselves by inspection or otherwise as to their accuracy. No person in this firms employment has the authority to make or give any representation or warranty in respect of the property.